

REVISIONS						
ZONE	LTR	DESCRIPTION	CHANGE No	DATE	BY	APPR'D
AA		INITIAL RELEASE	DR48398	09 JUL 14	RMB	BLM
AB		REVISED TUBES, SHORTER LENGTH	DR51016	24 FEB 15	RMB	BLM

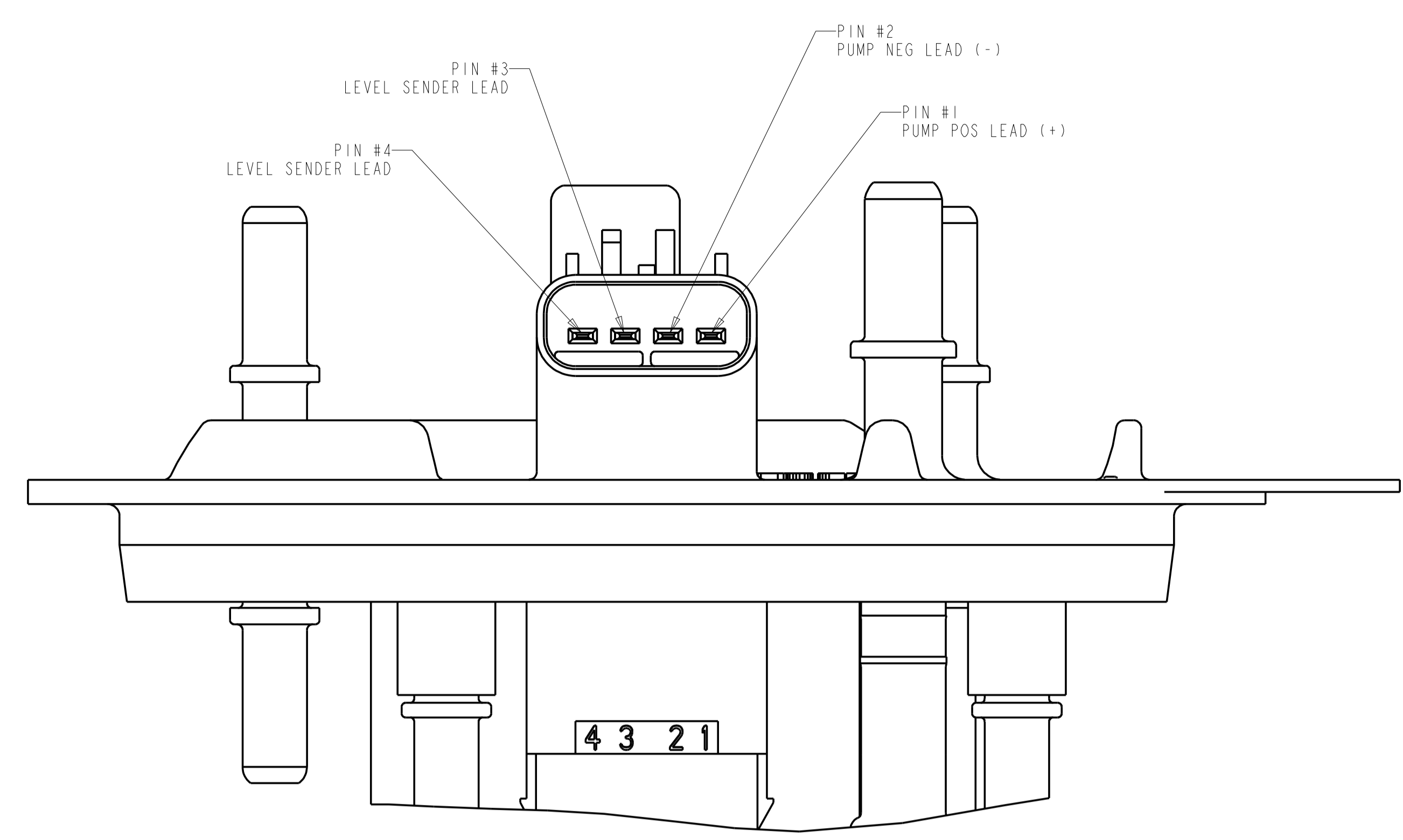

E-CONNECTOR PIN OUT DETAIL
PARTIAL VIEW IN DIRECTION OF ARROW "X"
SCALE 2:1

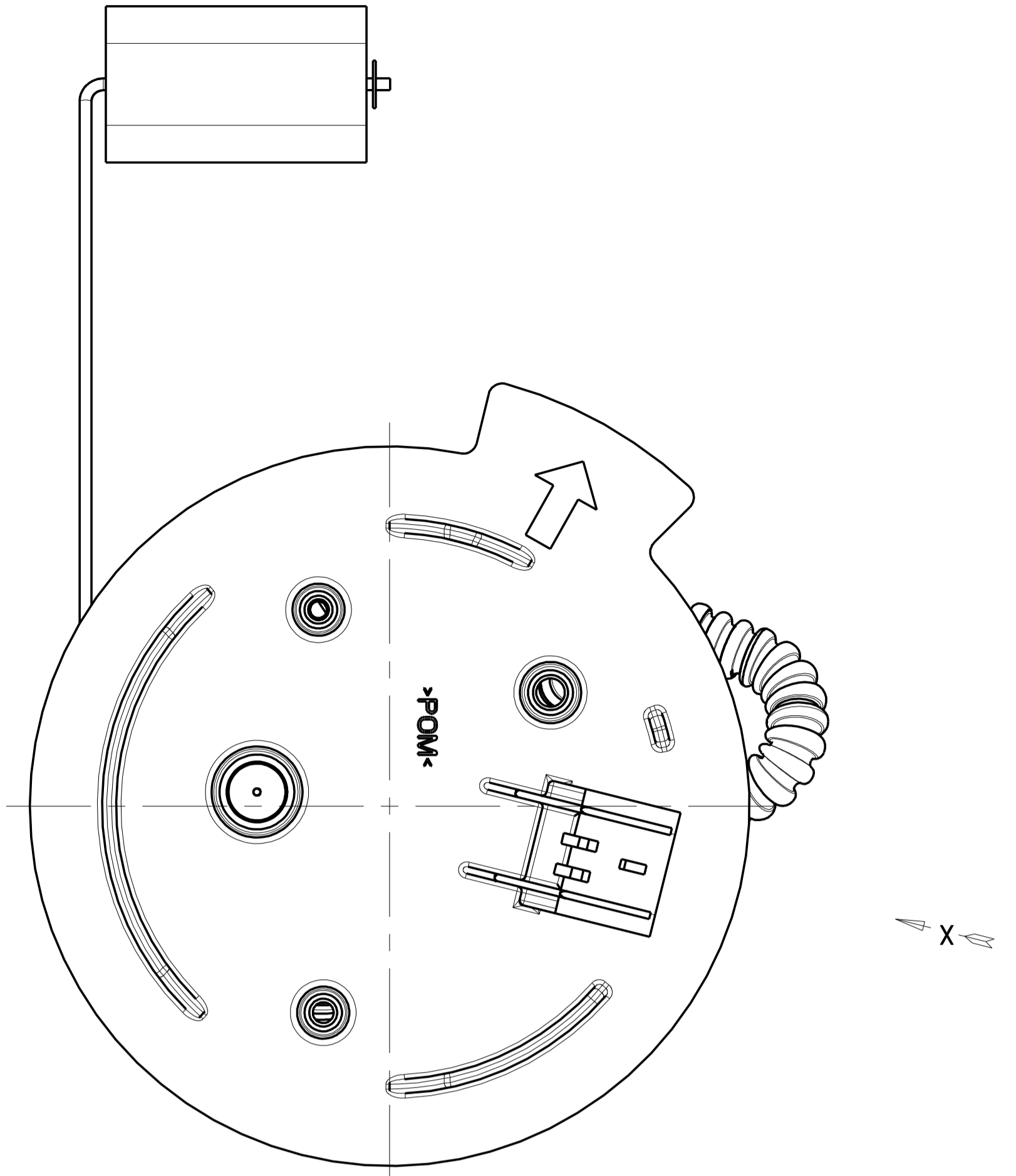
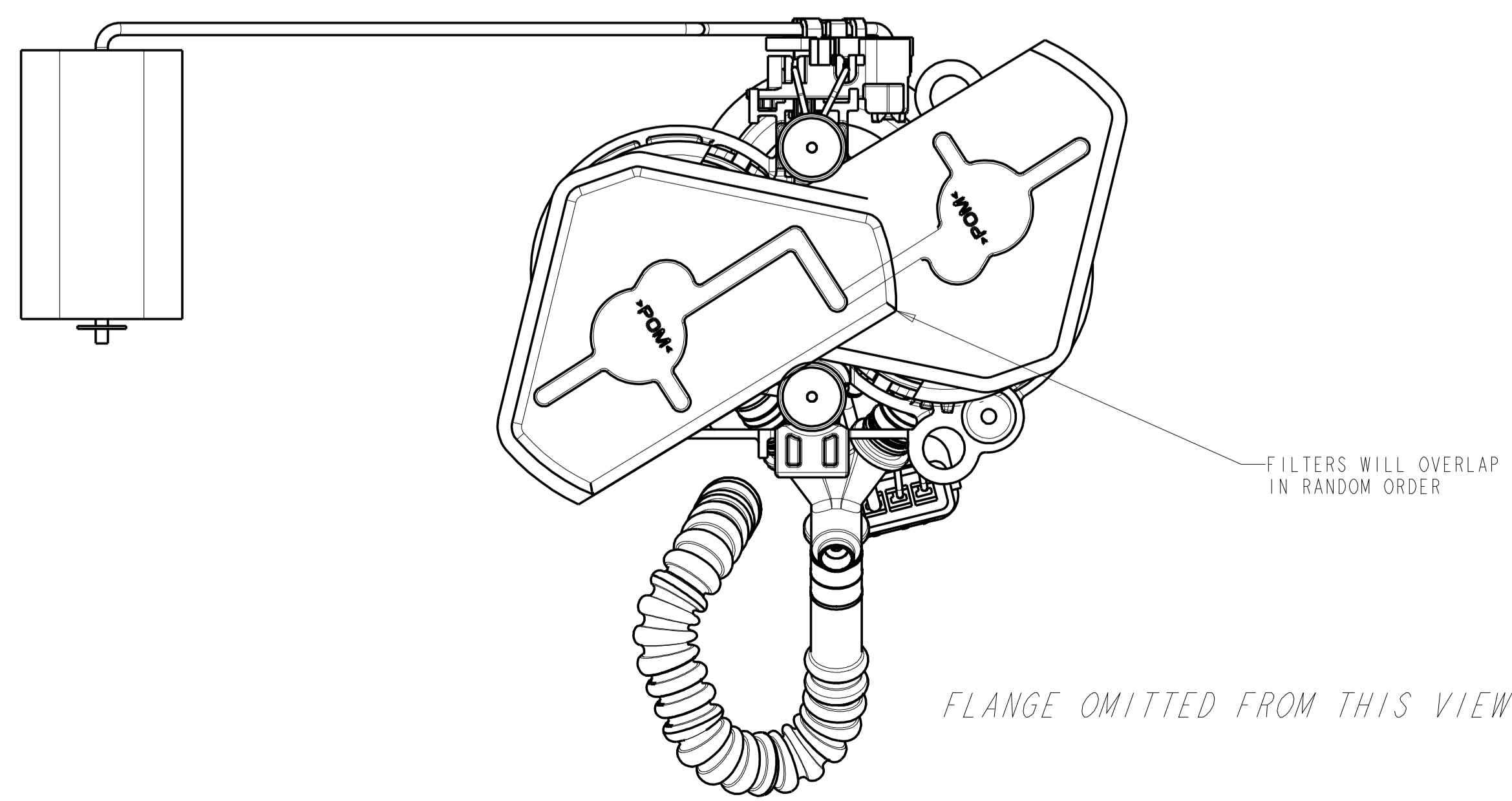
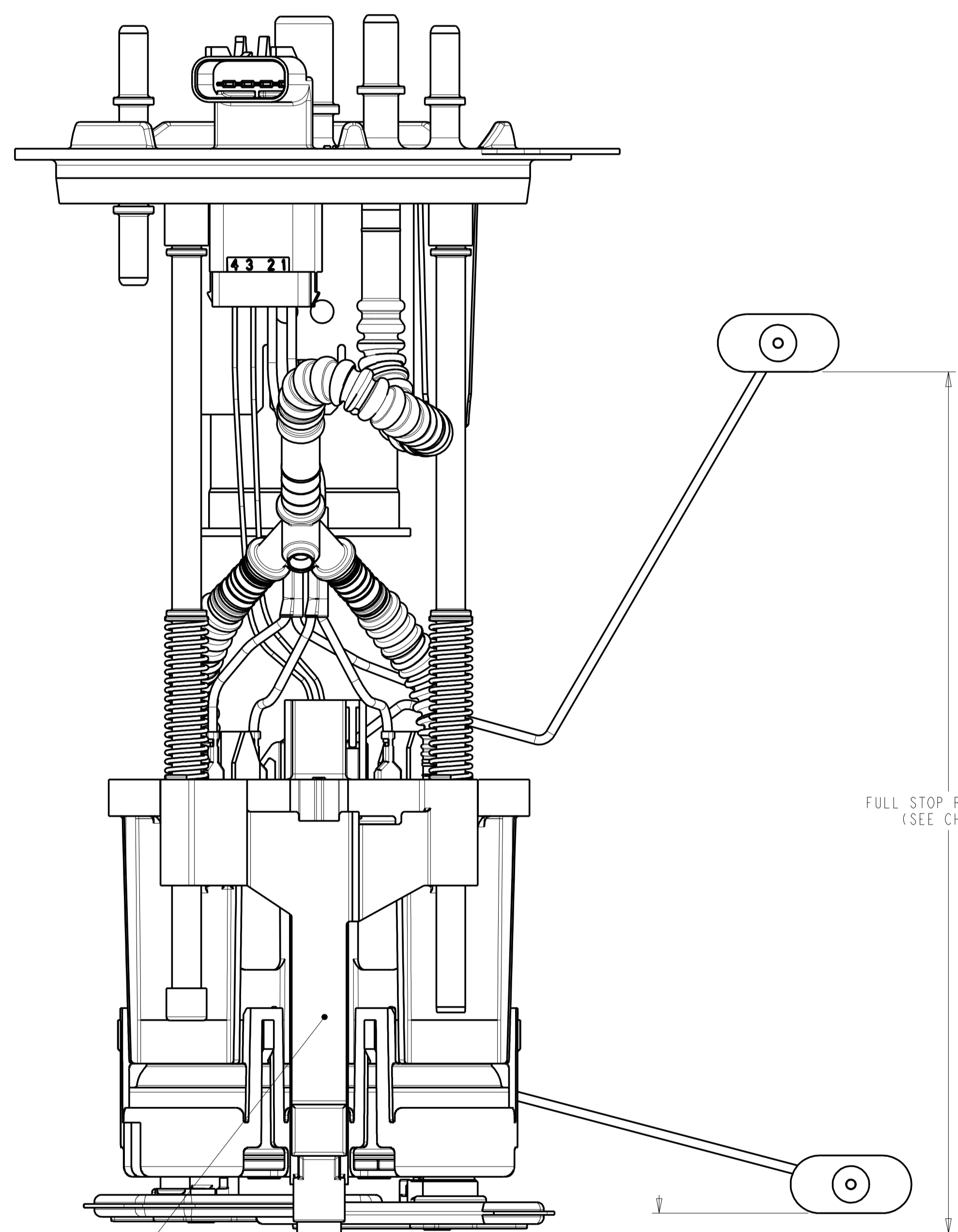
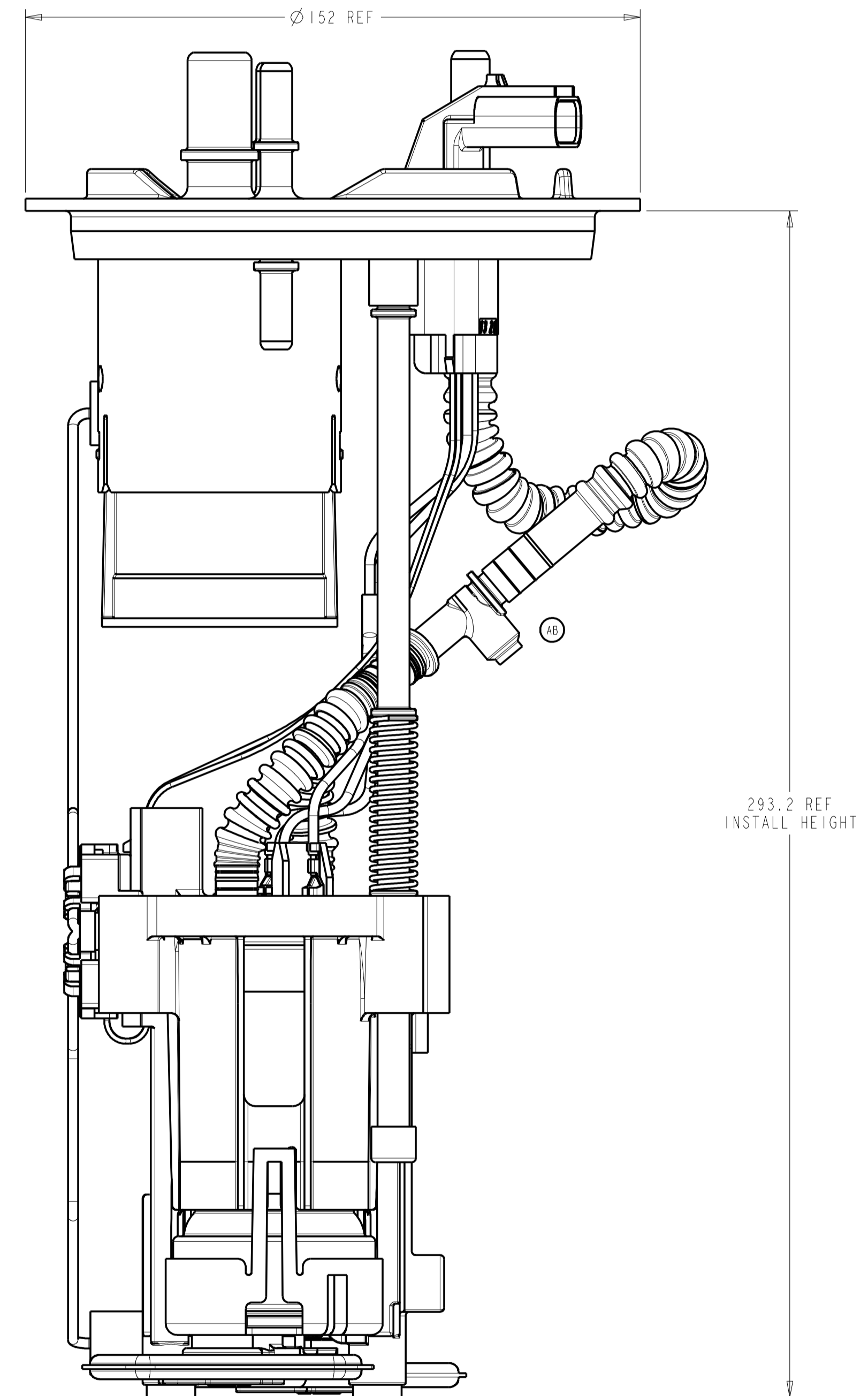
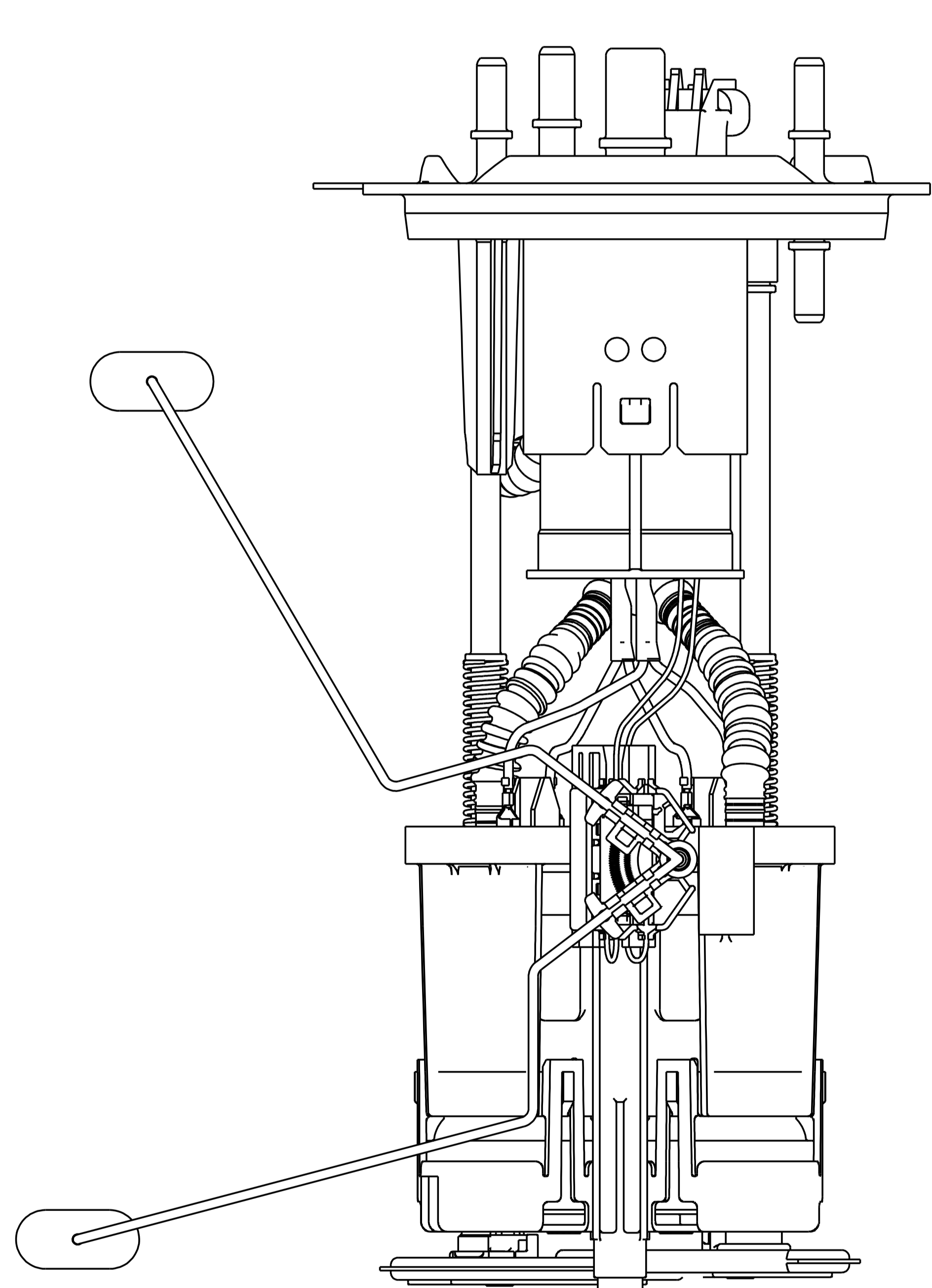

FLOAT POSITION	HEIGHT (mm)	RESISTANCE (Ohms)
FULL STOP	235.0 REF	160 ± 4
EMPTY STOP	5.0 REF	16 ± 2

- NOTES:
- SPECIAL CUSTOMER PACKAGING REQUIREMENTS MAY CALL FOR THE ADDITION OF SPECIFIC LABELS NOT SHOWN ON THIS DRAWING.
 - MODULE TO BE PACKAGED USING COMPONENTS NOTED ON BOM SO THAT CONTAMINATION FROM FOREIGN MATERIAL IS PREVENTED:
- PLUG PROTECTORS ON PORTS
- POLY BAG
 - SHOWN WIRE ROUTING MAY DIFFER FROM FINISHED PRODUCT.

METRIC
ALL DIMENSIONS ARE IN MILLIMETERS

DO NOT SCALE

DECIMAL TOLERANCES UNLESS OTHERWISE SPECIFIED
ONE PLACE ±0.25 TWO PLACE ±0.13 ANGLES ±1°

THIRD ANGLE PROJECTION

DIMENSIONS IN ACCORDANCE WITH ASME Y14.5 - 2009

TI Automotive
630 COLUMBIA ST
CARO, MI 48723
+1 989.673.7127

ENGINEER	B. WIDDLETON	07 JUL 2014	MATERIAL/SPECIFICATION:
DES. MANAGER			N/A
DESIGNER	R. BRUBAKER	07 JUL 2014	

CAD SYSTEM: PROE SCALE: 1:1 SHEET NO. 1 OF 1

REFERENCE TYPICAL: PLM REF: 000112582/AA P/W REFERENCE TYPICAL: 2D: AR0037526/AB
REFERENCE TYPICAL: 3D: AR0037524/AB

DRAWING NAME: FUEL MODULE OUTLINE
DATE: AD DRAWING NUMBER: TU270SF

▽ DENOTES SAFETY CHARACTERISTIC
◊ DENOTES SIGNIFICANT CHARACTERISTIC
◑ DENOTES HIGH IMPACT CHARACTERISTIC

© 2014 AUTOMOTIVE COMPONENTS, INC. ALL RIGHTS RESERVED.
THIS DRAWING IS PROPERTY OF AUTOMOTIVE COMPONENTS, INC. AND IS NOT TO BE REPRODUCED, COPIED, OR TRANSMITTED IN ANY FORM OR BY ANY MEANS, ELECTRONIC OR MECHANICAL, WITHOUT THE WRITTEN PERMISSION OF AUTOMOTIVE COMPONENTS, INC. THE INFORMATION CONTAINED HEREIN IS UNCLASSIFIED EXCEPT WHERE SHOWN OTHERWISE. THIS DRAWING IS PROVIDED FOR INFORMATION ONLY AND IS NOT TO BE USED FOR THE DESIGN OR CONSTRUCTION OF ANY PRODUCT WITHOUT THE WRITTEN PERMISSION OF AUTOMOTIVE COMPONENTS, INC. THE INFORMATION CONTAINED HEREIN IS UNCLASSIFIED EXCEPT WHERE SHOWN OTHERWISE. THIS DRAWING IS PROVIDED FOR INFORMATION ONLY AND IS NOT TO BE USED FOR THE DESIGN OR CONSTRUCTION OF ANY PRODUCT WITHOUT THE WRITTEN PERMISSION OF AUTOMOTIVE COMPONENTS, INC. THE INFORMATION CONTAINED HEREIN IS UNCLASSIFIED EXCEPT WHERE SHOWN OTHERWISE.